

Licensable activities will be in the sports bar, outside eating area or the front bar.
There will be no furniture blocking any fire exits.
we will have sofas and tables in the bar areas.

Fire Exits are marked green on the floor plan

There are fire blankets and fire extinguishers in the kitchens and takeaway area. There are fire extinguishers in the lounge and bar area.

There are two toilet areas, one disabled toilet and one urinal toilet area for the public. There is one staff toilet which is near the kitchen and storage area.

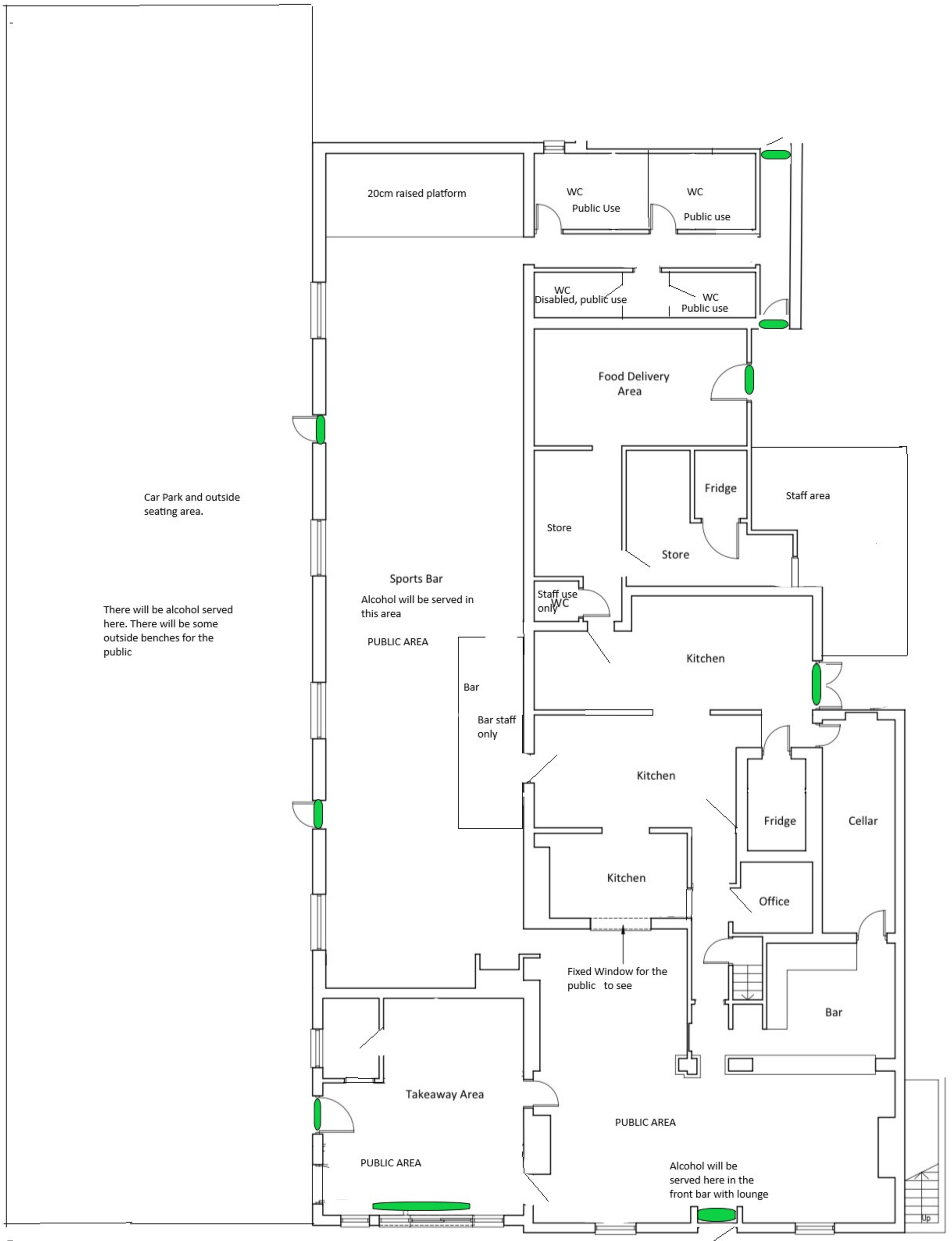

PROPOSED PLAN 1:100